

**WESTECH**  
HEALTH CARE LTD.



A world of Ergonomic Chairs





Tango

Activity Chairs for home, school, and the work place.

**WESTECH**   
HEALTH CARE LTD.

Our goal is to help Canadians of all ages live independently with dignity and respect by offering innovative health care products.

Follow us @westechhealthcare

 1 844-323-0022  
 sales@westechhealth.com  
 www.westechhealth.com



## Ergonomics and safety

VELA develops chairs for people to be able to maintain a high level of activity and independence.

Through collaboration with therapists and eighty years of expertise in ergonomics, VELA offers a wide selection of ergonomic chairs that support activity throughout the day. VELA offers chairs for kids, young people, adults and elderly people with disabilities. We also offer basic chairs and stools for caregivers, therapists and assistants. Through ergonomics, the VELA chair contributes to independence, activity, better work environment as well as comfort and safety for people with disabilities, their care givers and therapists.

Chairs from VELA contribute to an easier day for people with disabilities. VELA offers ergonomic chairs, fitted for, e.g., specific tasks, functions and special needs. The chairs are easy to adjust and the ergonomic design of e.g. seat, backrest, armrests and various accessories contribute to safe and healthy positions of function.

## Advice on ergonomics

Good ergonomics is important for people with disabilities, since many activities take place while sitting.

1. Good ergonomics is not one specific sitting posture, but variation in switching between using a work chair, easy chair or maybe a wheelchair.
2. A sit-stand chair, with a brake, relieves and stabilises a standing work position and allows for change between a sitting and a standing work position.
3. Use the chair's seat and backrest adjustment options to vary your sitting posture – move and change position in relation to your work tasks.
4. Move the chair close to the task and avoid postures where you have to stoop and strain your back or your neck.
5. Use the chair's height adjustment and seat tilt to avoid working with lifted shoulders and arms. The height adjustment also facilitates the caregiver's work during transfers.

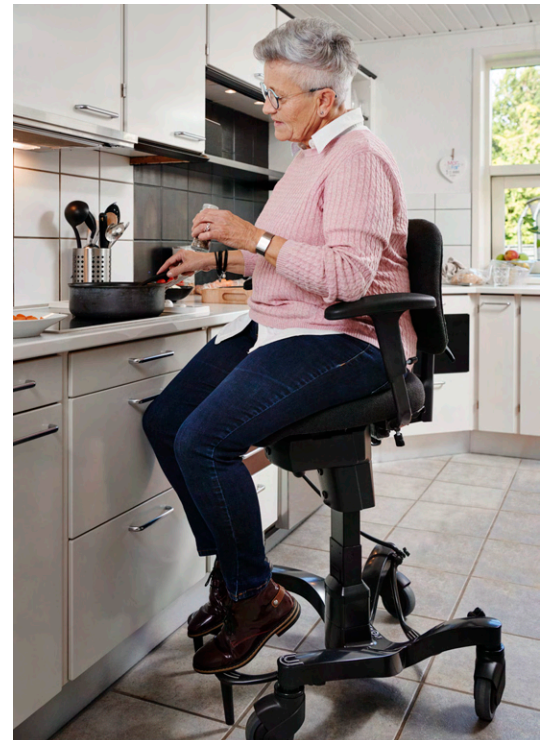

Assistive technologies can make a huge difference in the everyday life of people with disabilities, as they enable execution, activity and participation in everyday activities. This applies to the VELA Chair, a device developed by VELA in the 1970s. VELA has become popular in many homes by providing people with disabilities and physical limitations with greater independence.

The VELA Chair's reason for being is the same as it was back in the 70s: the central brake of the chair provides safety and liberty to perform various activities. At the same time, the VELA Chair is a mobile chair with smooth-running wheels that allow the user to walk the chair around in a seated position.

A VELA Chair is available with manual or electrical height adjustment. The electric height adjustment reduces inconvenience and pain often associated with movement.



Furthermore, the electrical height adjustment also supports people who are fatigued or with reduced balance and power in the legs to mobilise themselves from a sitting to standing position.

On the following pages, concrete benefits from users and care providers are described from their perspective based on everyday activities at home.

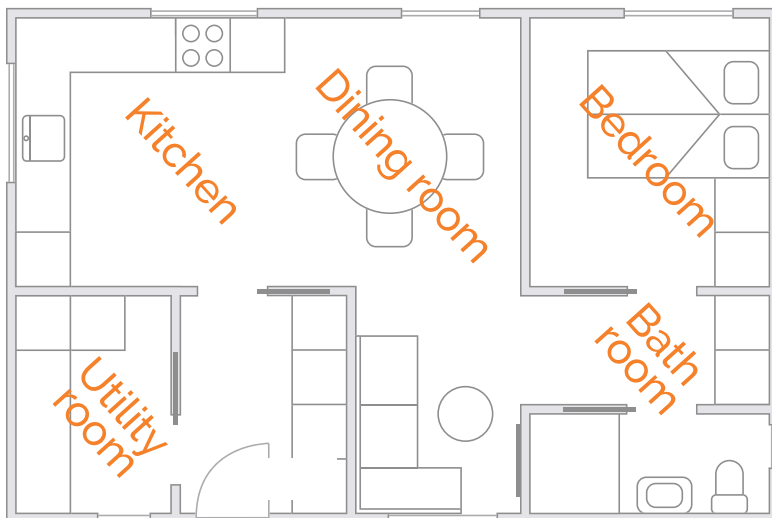

## A VELA Chair provides self-reliance/ independence in relation to:

	Mobilisation and transferring ✓
	Increased Reach ✓
	Cooking ✓
	Refrigerator ✓
	Top cabinet ✓
	Dishwashing ✓
	Laundry ✓
	Hanging up laundry ✓
	Ironing ✓
	Personal hygiene ✓
	Toilet Visits ✓
	Closet ✓
	Dressing ✓
	Watering plants ✓
	Cleaning ✓
	Vacuuming ✓



# Home - Activity chairs



**Kitchen work** Daily activities in a kitchen such as preparing food, making coffee for yourself and your guests are fundamental to most people. Kitchen work mostly takes place while standing and requires precision, strength and stability, for instance when chopping vegetables or slicing bread.

**Sedentary work** Being able to carry out daily chores at home independently, without relying on help from others, gives most people an improved quality of life and a meaningful existence. Chores such as ironing, vacuum cleaning, cooking and doing the laundry require good balance and stamina, which can be a challenge for some people.

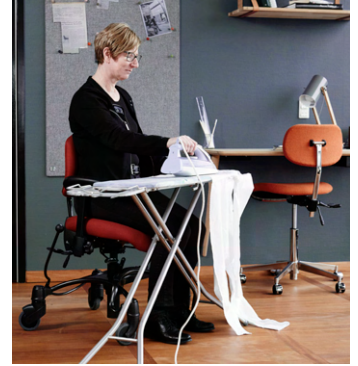

## Finding the right chair

VELA has many years of experience of finding just the right chair, so people with disabilities can maintain their activity level and remain as independent as possible. VELA has several types of customised chairs with seats and backs in different sizes, so it is possible for the user to achieve a comfortable, active and ergonomic work posture.

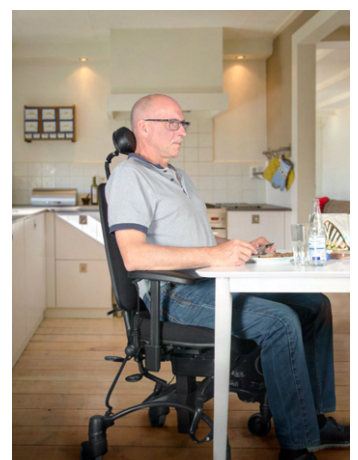
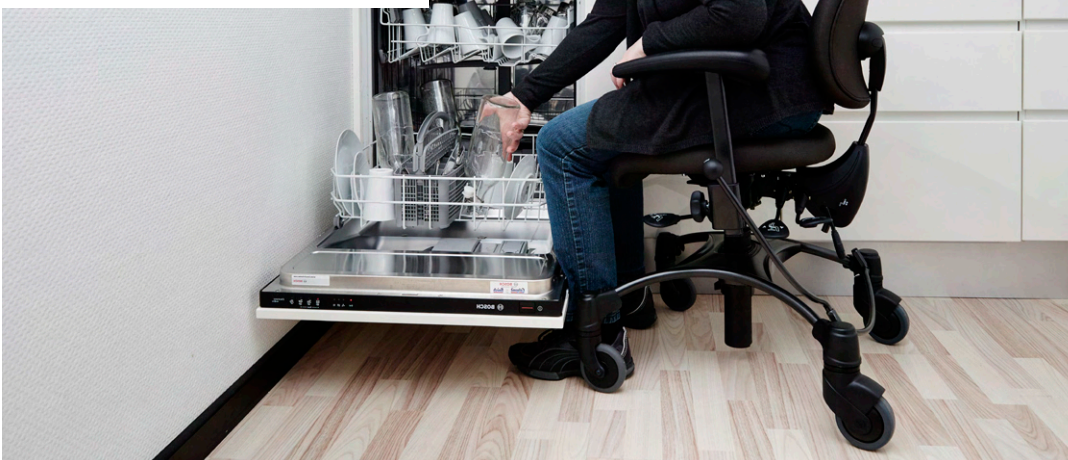

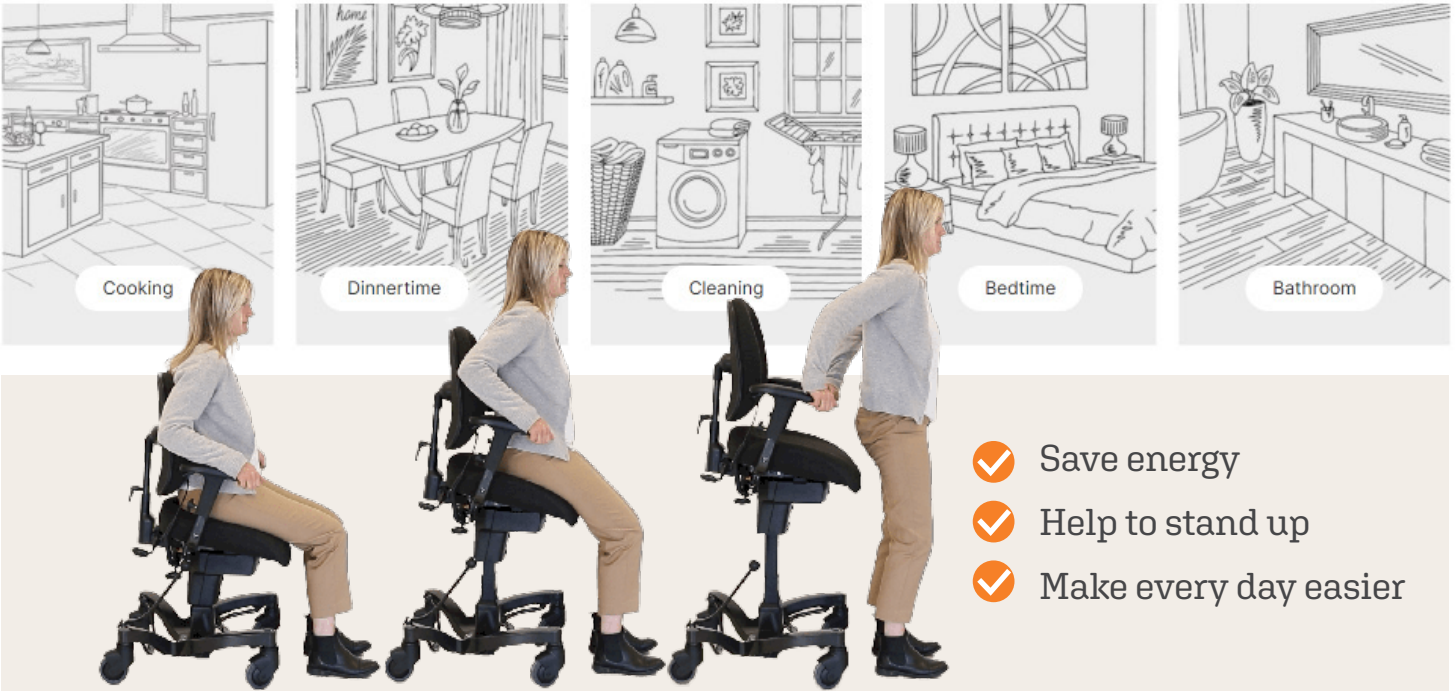

## Chairs with electric height adjustment have many advantages

In many respects, chairs with electric height adjustment can be an essential help in everyday life, positively impacting mobility, balance, and independence.

Electric height adjustment can be advantageous if the user has reduced ability to sit-stand, often experiences dizziness or has pain in their hands.

The electric height adjustment is also suitable for those who need the chair to raise and lower gently, e.g. if you suffer from a back disorder or diminished lower extremity function.



**Standing work** Quality of life for people with disabilities may be linked to being able to do a job, e.g. with reduced hours or a flexijob. Quality of life can also mean being able to perform everyday activities independently.

**Healthy back** A healthy and strong back can, for some, seem incompatible with a long working day involving sedentary work. However, even if you work in an office and sit for most of the day, you can still strengthen your back and prevent back pain.





# Features to help you Move





VELA Tango 700  
(Contour backrest)



VELA Tango 700EL  
(Active Backrest)



VELA Tango 600ES



VELA Tango 600S

VELA Tango is a customized mobility aide developed for people with disabilities to increase independence and activity at home, the workplace and school. VELA Tango chairs have a unique central brake which provides a safe and stable work base. VELA Tango is an ergonomic activity chair that provides mobility and support for those with pain, balance issues or weakness from stroke, cardio pulmonary issues or neurological conditions - fall prevention is critical to staying independent.

## VELA TANGO CHAIRS

### VELA Tango 600S

Vela's newest model of pneumatic height adjustment chair

### VELA Tango 600ES

Vela's newest electric height adjustment chair.

:: The Vela Tango 600S/ES is a new generation of activity and school chairs. they are particularly suitable for children and young people who need stability, comfort and "calm" in the sitting position to concentrate.

:: User Weight up to 80kg (176lbs)

:: Seats and backs available in 3 different sizes

VELA Tango 700 Pneumatic height adjustment chair

VELA Tango 700EL Electric height adjustment chair

:: Stable and safe chair with central brake

:: User weight up to 160 kg (352.74 lb)

:: Easy-adjustable seat, backrest and tilt

:: Two new series of ergonomically designed seats and backrests to fit your need for comfort and support.

:: Excellent support and sitting comfort.

:: Seats and backs available in 4 different sizes and active or contour styles.

## GREAT SITTING COMFORT

With a VELA Tango 700/700E, you can choose between two different series of ergonomically designed seats and backrests Both Active and Contour seating are available in 4 different sizes:

'Active' seats and backrests offer great comfort and light support. It comes in various sizes to fit your body and support needs. 'Contour' seats and backrests offer excellent comfort and a high degree of support. Both the seat and backrest are shaped with side support that helps stabilise your sitting position.

The VELA Tango has an electric lift that moves up and down with a touch of a button. Because of that, you can reach things on the top shelf or low in the cupboard. The electric lift can also help you to get up from the chair.

If you have substantial balance and strength in your legs to use a manual height adjustment, you can choose a VELA Tango 600 or 700 and enjoy the safety and stability our braked chair offers.

Thanks to soft and large wheels, it is easy to walk the chair around safely and smoothly, even on tiles and uneven floors. In addition, the chair comes in various seat heights to make sure it fits your size perfectly.

An easily accessible handbrake provides safety when performing daily activities, so you don't have to worry about the chair moving away from under you.



# Vela Tango Chairs - Heavy Duty



VELA Tango 300

VELA Tango Heavy Duty chairs can accommodate users up to 300 kg to become more self-reliant using a robust VELA chair. This means that it will be possible to mobilize and be more active in everyday life without unnecessary fatigue. The user can push/walk around, seated, as the chair has wheels, and at the same time have a stable, safe chair with a hand-operated brake. Electric height adjustment helps the user to get up and sit down and easily change the seat height.

## VELA Tango 300

- :: The chair is for heavy users and can handle weights of 200kg (440lbs)
- :: Reinforced base adjustable armrest bars and backrest bar

## Heavy Duty Tango chair with electric height adjustment



VELA Tango 300EL



VELA Tango 310EL

- Perfect when you need to sit down at activities where you would stand before, for example, due to pain or lack of balance or strength in the legs.
- The VELA chair provides a safe and stable workplace that you can adjust in height electrically, which helps the person independently mobilise from a sitting to a standing position and vice versa.
- Suitable for many activities (up high) as you are not dependent on the help of your feet and legs with electric height adjustment, and therefore have the option of a higher sitting height than on a manual VELA chair.
- Reduces unpleasant bumps and jolts that may occur in with a manual height adjustment, which causes pain and discomfort for some people.

- :: Electric height adjustment gives a comfortable and safe change of seat height
- :: Stable and safe chair with central brake
- :: Brake and armrests provide safety and support

## VELA Tango 300EL

- :: A heavy duty chair designed for user weights of up to 200 kg (440.9 lb).
- :: Sitting height can be adjusted while sitting in the chair

## VELA Tango 310EL- electric height adjustment

- :: Robust chair approved for 300 kg user weight. Resists sudden weight impact when you "drop" into the chair.
- :: Electric height adjustment assists you with sit-to-rise.
- :: Has a 4XL seat (W: 72xD: 50 cm) and a CX backrest (W: 38xH: 43 cm) as standard.

### TANGO310E

Up to 300 kg  
Elec. aid to get up  
4XL-seat  
(w:72cm d:50cm)





## Accessories provide optimal customisation for the user

All VELA chairs have a wide range of accessories so that the chair can be adapted to the needs of each user. VELA offers solutions in upholstery, comfort, support, grip, electrical setting and working environment. There are many accessories for VELA chairs, including many different types of backrests and seats that can be combined to suit individual needs.



**People with difficulties in walking and mobility problems may benefit from:**

- :: Extra-large smooth-running wheels that make it even easier to move the chair.
- :: Footrest on which to rest the feet while sitting and working. Furthermore,
- :: It is possible to pull and push yourself around using the arms, while the feet rest on the footrest.



**People with pains and reduced joint mobility may benefit from**

- :: T-grip that reduces twists in the body and back, when using the brake on the chair.

- :: Large backrest with air pump that allows for variation and graduation of backrest support.



**People with reduced power in arms and hands may benefit from:**

- :: Arthritis grip that makes it easier to use the chair's adjustment options as they are placed parallel to the seat of the chair instead of below the seat. This means that you do not need to reach so far to get to them, nor is it necessary to use as much effort as with the standard grips.

- :: Special seats, backrests, body supports, side supports and headrests **contribute to an ergonomic seat position** that promotes activity

- :: Covers for seats and backrests are an advantage when the chair is used by different users or when there are **challenges related to hygiene**

VELA offers a wide range of accessories that provide the possibility to customise the chair to the individual user

- :: Armrests are available in different designs and with different cushions that can **relieve and support the arm** in the right position. Armrests contribute to **increased comfort**, provide **safety** and **facilitate entry and exit** of the chair, for those who have balance problems or reduced power in the legs

- :: Push bar **improves the working environment of the care provider**, e.g. when the user is moved sitting in the chair
- :: Special grips, e.g. for people with arthritis, can **ease the adjustment** of the brake, seat and backrest







## Danish Quality

VELA is a Danish family-owned company, founded in 1935 by Vermund Larsen. VELA is headquartered in Denmark and has its own development department, production and upholstery workshop.





"Our goal is to help Canadians of all ages live independently with dignity and respect by offering innovative health care products."



Personal Care  
Products



Rehab Products



Customer Service



Education  
& Technical Support



220125 February 12, 2024 3:32 PM



**WESTECH**  
HEALTH CARE LTD.

Westech Health Care Ltd.  
1145 - 5255 McCall Way NE, Calgary, Alberta T2E 7J5  
2-8400 Parkhill Drive, Milton, Ontario L9T5V7

[www.westechhealth.com](http://www.westechhealth.com) :: [orders@westechhealth.com](mailto:orders@westechhealth.com) :: [sales@westechhealth.com](mailto:sales@westechhealth.com) :: 1-844-323-0022



**For more information:**

[www.westechhealth.com](http://www.westechhealth.com)

844-323-0022

Follow us @westechhealthcare

*Westech Health is on a mission to enhance people's lives by providing access to industry leading healthcare product manufacturers and developers.*